

1 Existing Site Survey_Proposed Demolition Works
1:1000

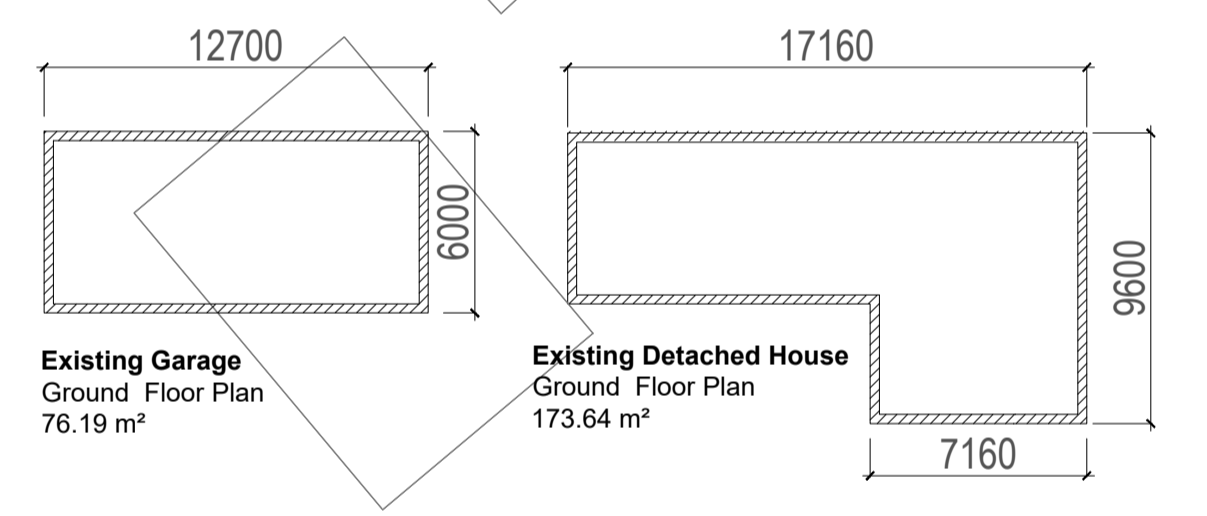

3 Existing Site Layout Plan_Proposed Demolition Works
1:250



NOTE:
Refer to P19-147K-RAU-XX-XX-DR-A-31701
for detailed demolition drawings
Refer to Existing Site Survey for orientation

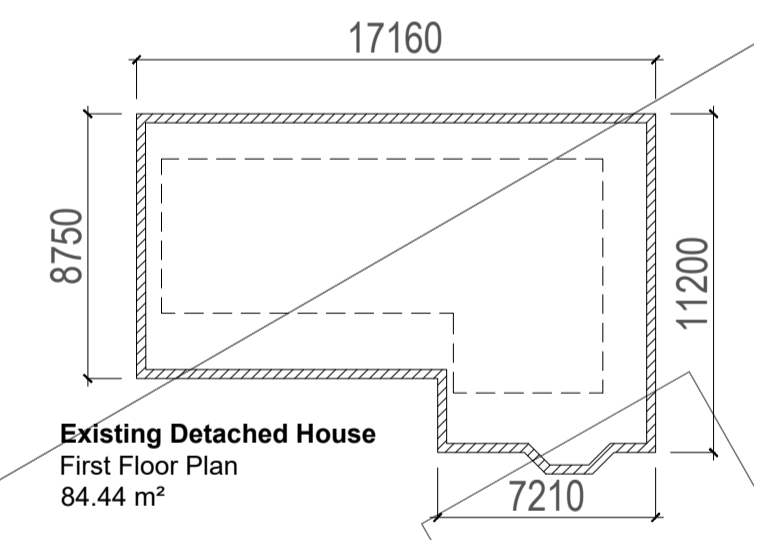

2 Existing Building Plans For Demolition
1:250



Existing Garage / Shed



Existing Detached House



Notes:
Do not scale from this drawing. Use figured dimensions in all cases. Verify dimensions on site and report any discrepancies to the architect immediately. This drawing is to be read in conjunction with the Architects Specifications, Fire Certificate, LAC, other conditions issued in writing and reports. Contractor is responsible for:
1. All information that pertains solely to the fabrication processes or to the techniques of construction.
2. All coordination of the work of all trades.
3. Hearing consistency with the contract documents.
This drawing is copyright and may only be reproduced with the architect's permission.

Drawing Notes:

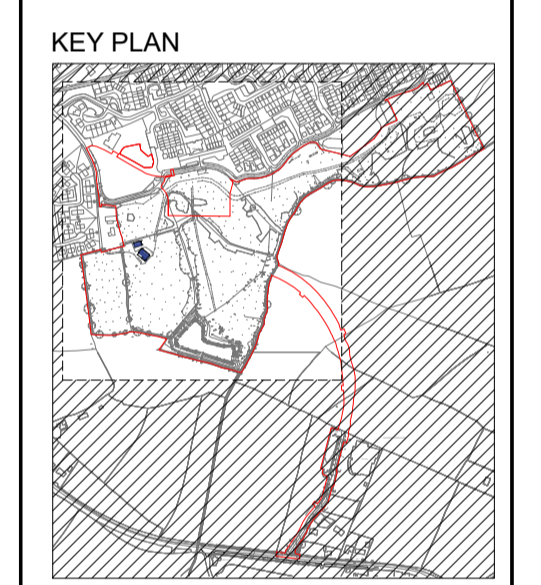

Application Site Area
157,395m² | 15.73 Hectares

Proposed Demolition Works
334.27 m²

REV	DATE	DRN	DESCRIPTION
P03	27.05.21	LB	Issued for Planning
P02	06.11.2020	LB	Issued for Planning
P01	06.11.2020	GM	Issued for Planning
REV	31.05.20	LB	Issued for Information

reddy architecture + urbanism

Reddy Architecture + Urbanism
41 Dean Street,
Kilderry,
RG5 PZ81

T. +353 (0)56 7762697
W. www.reddyarchitecture.com
E. info@reddyarchitecture.com

Client Details:
AXIS Construction

Project Details:
Proposed Residential Development
at Clonattin, Gorey

Drawing Title: Existing Site Demolition Plan	
Job No: P19-147K	Date: 30/01/2020
Status: 03 Design Development	Scale@A1: 1:1250 - 1:250
Purpose: PLANNING	Drawn By: LB
Drawing Number: P19-147K-RAU-XX-XX-DR-A-31800	Checked By: MK
	Revision: P03